

North American Company land

Thos Montgomery

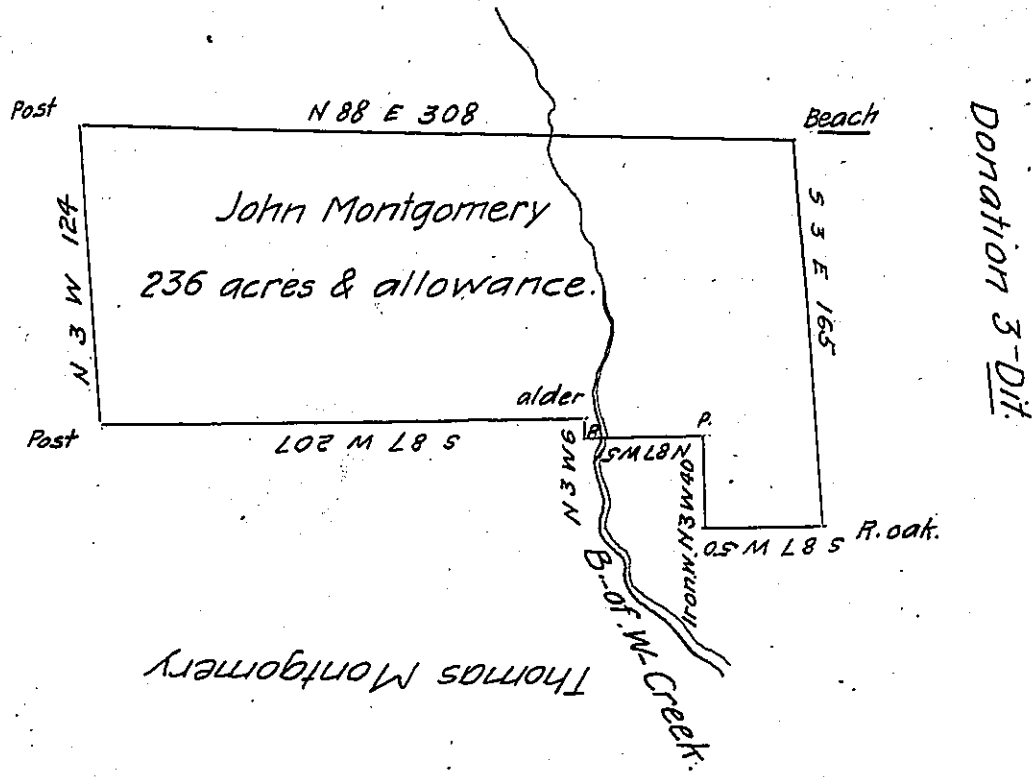

A draft of survey situate in Wolf Creek Township Mercer County containing 236 acres and the usual allowance Surveyed December 13<sup>th</sup> 1839 for John Montgomery Inpersuant of an actual settlement made and continued for 40 years past first by W<sup>m</sup> Montgomery Senior and now by his sons March the 14<sup>th</sup> 1839

B. Alexander D.S.

John Taylor Esq. S.G.

IN TESTIMONY that the above is a copy of the original remaining on file in the Department of Internal Affairs of Pennsylvania, made conformably to an Act of Assembly approved the 16th day of February, 1833, I have hereunto set my Hand and caused the Seal of said Department to be affixed at Harrisburg, this ninth day of February 1905

*Isaac D. [Signature]*  
Secretary of Internal Affairs